

INLAND EMPIRE DRIVELINE

GM DRIVESHAFT & U-JOINT MEASURING INSTRUCTIONS

Please review and complete this form to provide us with the correct measurements for your new TKO driveshaft. When complete, sign at the bottom and fax to Classic Motorsports Group. Our fax # is: (760) 438-2271. As soon as we receive this form we will have your driveshaft built and sent out promptly.

Driveshaft

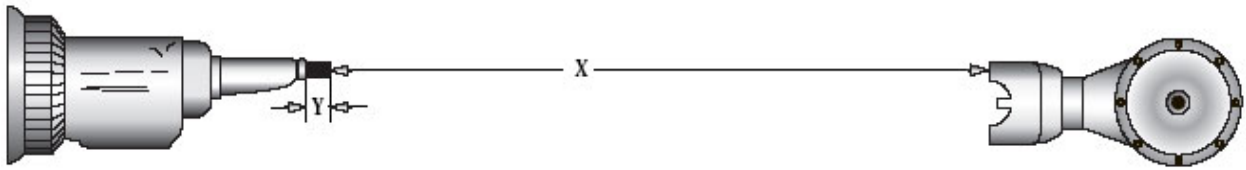

- **With the full weight of the vehicle on the suspension**, measure from the tip of the **transmission output shaft** (not the end of the transmission casing) to the centerline of U-joint at the rear pinion. This will be the flat surface where the U-bolt hole is drilled. **Write this measurement here:**_____.
- Also, please let us know the make and model of your **differential**:

U-Joint Size

1. Measure for rear u-joint size at the pinion yoke.
2. These dimensions must be accurate. If you don't get them, check for wear at the "E" measurement.

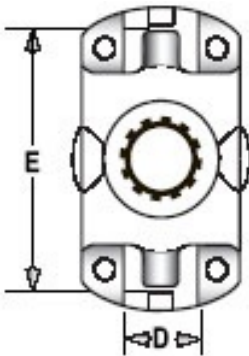

Measuring based on the diagram at left, you should obtain one of the following pairs of measurements for "E" and "D." Make note of these measurements for use in the order form.

- E = 3-7/32" D = 1-1/16" (1310)
- E = 3-7/32" D = 1-1/8" (Ford 8")
- E = 3-5/8" D = 1-1/16" (1330)
- E = 3-5/8" D = 1-1/8" (Ford 9")
- E = 3-5/8" D = 1-3/16" (1350)

Please circle the measurements for your application.

Additional Information

Transmission Type (TKO/T56): _____

Car Year/Make/Model: _____

Engine size: _____ Blower (Y/N): _____ Nitrous (Y/N): _____

Horsepower _____ Will you be using slicks (Y/N) _____ -

Intended use of car (cruising, street fun, drag race, etc.): _____

Name: _____

Invoice # _____

Phone#: _____

Shipping Address: : _____

Signature: _____

Date: _____



2380 Camino Vida Roble, Suite M
Carlsbad, CA 92011

Phone: (760) 438-2244
Fax: (760) 438-2271
sales@cms-grp.com
<http://www.cms-grp.com>